

SV8100 – Telephones

Pre-Sales Support
UNIVERGE SV8100
Release 5

Doc. Version 5.00

Agenda

Overview

- DT3xx Digital phones

- DT7xx IP phones

- Modularity \ Upgradeability

- Adapters

- Analogue phones

- SIP terminals

- Compatibility



5 good reasons to choose SV8100 terminals and handsets

1. **Modular construction**

- the interchangeable design provides easy and cost-effective upgrades, helping to future-proof this businesses investment

2. **Customisable design**

- choose from a range of add-on line key modules, faceplates, LCDs, keypads and even printable side panels

3. **Customisable function keys**

- can be adapted to the exact individual requirements of a business

4. **User-friendly interface**

- little or no staff training required

5. **Unique Bluetooth handset option**

- provides wireless freedom from a desk, also links with Bluetooth headsets

In other words, Telephones are:

- Modular, Scalable and can be customized to the users need
- Both VoIP as Digital terminals are available
- XML open interface support for e.g.
 - Additional productivity tools
 - Information presentation to hotel guests
- Access to advanced applications
 - Voicemail, ACD,
 - Log on to any IP terminal
- Easy-to-use, intuitive interface
 - Large display, grey scale, backlit
 - Color touch screen



Menu-driven interface for:

- Check call logs
- Change settings
- Etc.

Easy access – Easy operation



Open menu

Browse

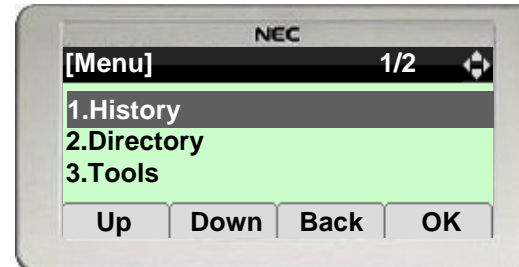

Unavailable items are grayed out

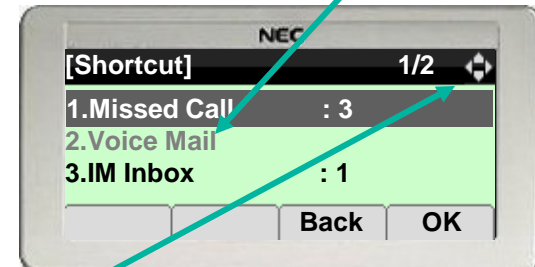

Touch screen menu's (DT750)

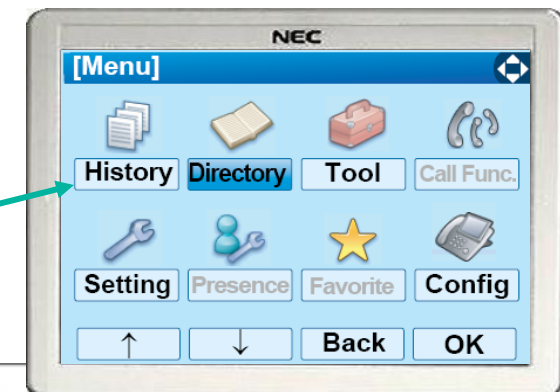

- XML is supported on all DT700 terminals
- Requires separate XML application server
- Provide information where no PC is available, e.g. hotel rooms
- Multi-Window Functionality (DT750 only)
 - With the multi-window support enabled on the DT750 terminal, you can link multiple productivity XML applications to one screen.
 - The NEC terminal now becomes an information portal to the multi-tasking world



DT750 - XML application examples:







UNIVERGE desktop terminal line up

Overview

IP Terminal

Digital Terminal

Type	Example	Type	Example
DT750			
DT730 -12D -24D -32D -DESI-less		DT330 -12D -24D -32D -DESI-less	
DT710 -2 (no LCD) -6D		DT310 -2 (no LCD) -6D	

Examples:

Product name	Model name	Commercial name	Description
DT310	DTL-2E(BK)	Digital Economy	2 button without display (Black)
DT330	DTL-8LD	Digital Value DESI less	8 button DESI-less with display
DT730	ITL-24D	IP Value	24 button with display
DT750	ITL-320C	IP Sophisticated	32 button DESI-less with color display

Agenda

- Overview
- DT3xx Digital phones**
- DT7xx IP phones
- Modularity \ Upgradeability
- Adapters
- Analogue phones
- SIP terminals
- Compatibility



Digital phones

Economy telephones

- DT310
- Roles
 - Office administrator
 - Workshop employee
 - Public user (elevator, etc.)

Value telephones

- DT330
- Roles
 - Team worker
 - Office administrator

Main features

- Message Waiting Lamp (3 color)
- Handsfree (Half Duplex)
- Not Upgradable
- DTL-2E
 - 2 Line keys
- DT310 DTL-6DE
 - Full dot black & white LCD display
 - 6 line keys
 - 4 softkeys, Help, Exit



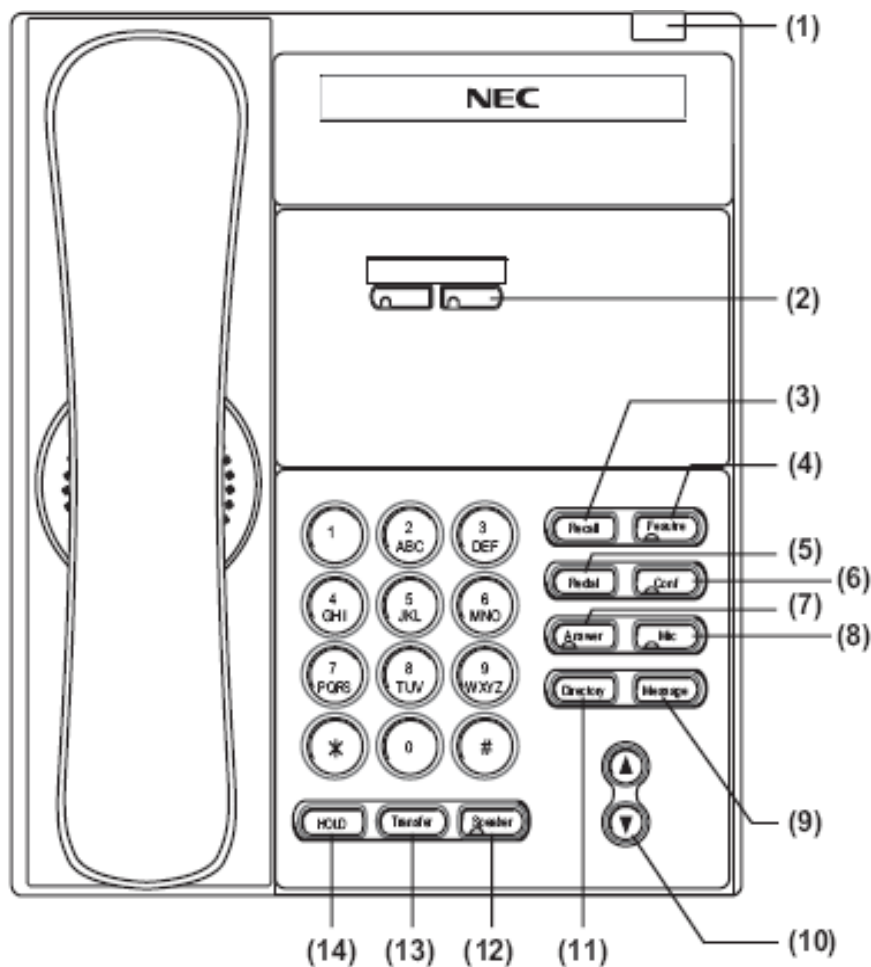

1. Call indicator \ MW lamp
2. Programmable keys
3. Recall
4. Feature
5. Redial
6. Conference (3 Party)
7. Answer
8. Microphone
9. Message
10. Up / down
11. Directory
12. Speaker
13. Transfer
14. Hold

Main features

- Upgradable
- Handsfree (Full Duplex)
- Directories
- Call History



DESI-less



12 line keys



24 line keys



32 line keys

Feature Comparison

Digital phones

Features	DT310	DT330
Characters x lines	Alphanumeric 2E: - 6DE: 24x3	Alphanumeric 28x4 (6x12 font) DESI-less: 28x4 (6x12 font)
Display	6DE: 168x41 dot matrix grayscale LCD, no backlit	168x58 dot matrix grayscale LCD Options: LCD backlit, 2 nd display
Backlit keypad	N/A	Yes
Line keys	2, 6	12, 24, 32, DESI-less: 8x4 pages
Soft keys	6DE: 4, help, exit	4, help, exit
Cursor keys	No	Yes
hands free	Half duplex	Full duplex
Security button	No	No
Headset I/F	No	Yes
MW / Call LED	3 color	3 color

Features	DT310	DT330
Optional adapters	No	Yes
Bluetooth hub	No	optional
Bluetooth handset	No	optional
XML support	Not applicable	Not applicable
Power	Via system interface	Via system interface optional AC-adapter
Codec	Not applicable	Not applicable
Downloadable ring tone	Not applicable	Not applicable
Main body tilt	Adjustable 4 steps (Angle 15 to 55 degree)	Adjustable 4 steps (Angle 15 to 55 degree)
Wall mount	Built-in	Built-in

Agenda

- Overview
- DT3xx Digital phones
- DT7xx IP phones**
- Modularity \ Upgradeability
- Adapters
- Analogue phones
- SIP terminals
- Compatibility



IP phones

Economy telephones

- DT710
- Roles
 - Workshop employee
 - Public user (elevator, etc.)

Value telephones

- DT730
- Roles
 - Team worker
 - Office administrator

Sophisticated telephone

- DT750
- Roles:
 - Executives \ Secretaries
 - Operator
 - Hotel presidential Suite

Features

■ Incoming Call \ MW Lamp (7 color)

- Customise on a per extension basis the flashing colour of the large Led
- Trunk Call \ Internal call \ Virtual Extension call

■ PC port

- NB: PC port will stay active while phone reboots,
 - There is a slight disconnection / reconnection during the boot cycle

■ Screen

- DT7XX allows screensaver to be displayed after configured time.
- URL access to retrieve screensaver
- As soon as any activity occurs, phone will change to relevant state
- Option: refer to URL, e.g. to show company logo

Main features

- Incoming Call \ MW Lamp (7 color)
- Full duplex hands free
- Firmware upgradable (hardware not)
- Power over Ethernet or AC
- Encryption
- Security button
- DTL-2E
 - 2 Line keys
- DTL-6DE
 - Full dot black & white LCD display
 - Limited XML interfac
 - 6 line keys
 - 4 softkeys, Help, Exit
 - Cursor keys



DT730 IP telephones

IP phones

Value telephones

- Gray scaledisplay with cursor keys
- Dial pad is backlit for easy viewing
- XML open interface
- SDK Available

Models:

- ITL-12D-1P(BK)TEL : 12 buttons
- ITL-12PA-1P(BK)TEL : 12 buttons PSA
- ITL-24D-1P(BK)TEL : 24 buttons →
- ITL-32D-1P(BK)TEL : 32 buttons →
- ITL-8LD-1P(BK)TEL : DESI-less →

DTxxx phones have small point on 5-key of dialpad to support visually impaired people
Braille phones to be arranged locally,

e.g. <http://www.dynamic-living.com/product/big-button-braille-phone/>

24 line keys



32 line keys



DESI-less



DT750 IP telephone

IP Sophisticated telephone (flagship)

- Color-LCD w/ Touch Screen
- XML Open Interface Support and XML SDK
- Backlit Dial-Pad
- Full Duplex Speakerphone
- Menu/Soft Key Operation
- Security Key
- Multi-colored (7) MW / Call led



Feature Comparison

IP phones

Features	DT710	DT730	DT750
Characters x lines	Alphanumeric 2E: - 6DE: 24x3	Alphanumeric 28x4 (6x12 font) DESI-less: 28x4 (6x12 font)	5.7"QVGA 320x240 dot
Display	168x41 dot matrix B/W LCD; no backlit; not tiltable	224x96 dot matrix 8 grayscale LCD; with backlit and tiltable	TFT(65536 color) LCDBacklit and tiltable
Line keys	2E: 2 6D: 6 With Red & Green LED	12/24/32 DESI less: 8 keys (4 key pages) With Red & Green LED	Via touch screen
Security Button	No	Yes (LED status indic.)	Yes (LED status indic.)
Fixed function key	2E: Function keys 6D: Cursor & Funct. keys	Cursor & Function keys	Cursor & Function keys
Soft key	2E: No 6D: 4 keys + "help", "exit"	4 keys + "Help", "exit"	4 keys + "Help", "exit"
MW / Call LED	3 color	7 color	7 color

Feature Comparison

IP phones

Features	DT710	DT730	DT750
Ten-key keypad	Ten-keys (0 - 9,*,#) - No backlit	Ten-keys (0 - 9,*,#) with backlit	Ten-keys (0 - 9,*,#) with backlit
Headset I/F	No	Yes	Yes
Speaker phone	Full duplex	Full duplex	Full duplex
MW / Call LED	3 color	7 color	7 color
Opt. adapters	No	Yes	Yes
Bluetooth	No	No	No
XML support	Yes (limited)	Yes	Yes
LAN	2 ports 10/100 Base-T	2 ports 10/100 Base-T	2 ports 10/100 Base-T
Power	PoE (802.3af) or AC	PoE (802.3af) or AC	PoE (802.3af) or AC
Codec	G.711, G.729A	G.711, G.729A, G.722	G.711, G.729A, G.722
Authentication	Yes	Yes	Yes
Downloadable ring tone	No	Yes (WAV file, 8/16kHz sampling)	Yes (WAV file, 8/16kHz sampling)

Feature Comparison

IP phones

Features	DT710	DT730	DT750
Main body tilt	Adjustable 4 steps (Angle 15 to 55 degree)	Adjustable 4 steps (Angle 15 to 55 degree)	Adjustable 4 steps (Angle 15 to 55 degree)
Wall mount	Built-in	Built-in	Built-in

Security Key



Protecting sensitive info:

- Security level is defined in terminal configuration
- Access via password input (user & admin)
- LED notification when security mode is activated
- Emergency call still possible

Future levels

	Personal Data	Corporate Data	Telephony Service
Low	X		
Middle	X	X	
High	X	X	X

SV8100 also supports:

- DT700 logon by extension nr & password
- Hot desking

802.1x Network Access Control – Authentication:

- EAPOL packet forwarding on the DT700 switch allows that PC can also use 802.1x authentication
- IP Phone has built-in 802.1x supplicant.
Protocol: EAP-MD5 (Certificates, EAP-TLS NOT supported)

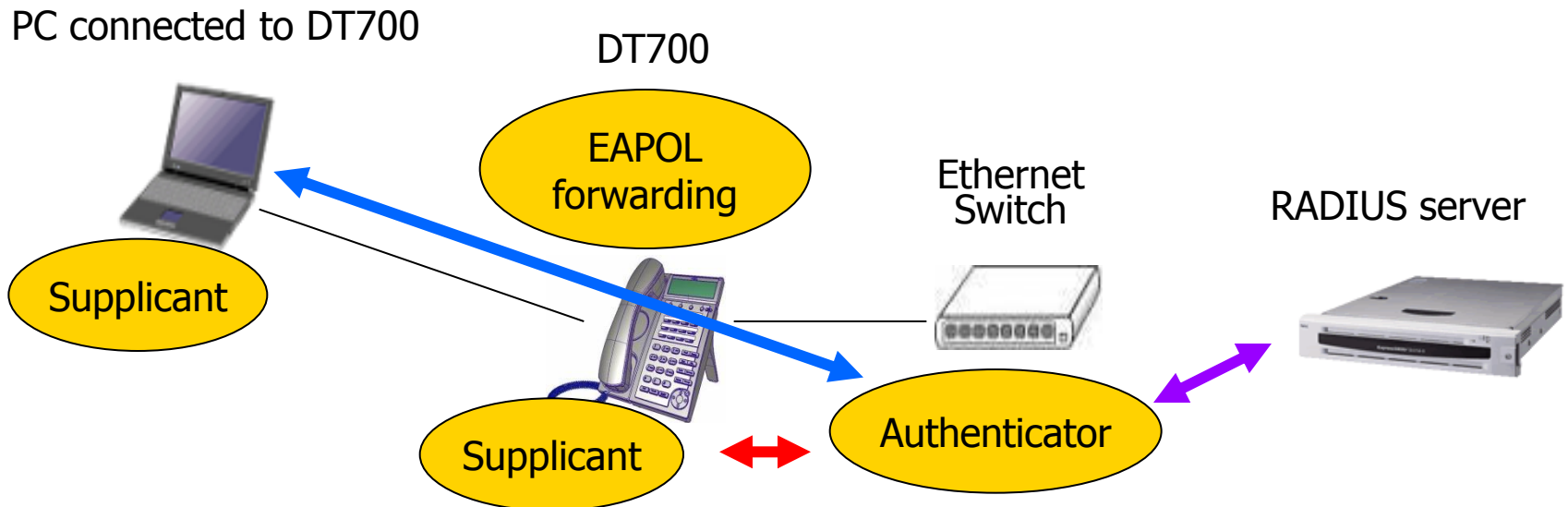

Note: 802.1x is an additional authentication besides password protected SV8100 user login, which is secured using MD5 mechanism

Secure RTP on DT7x0 phones:

- Encryption of voice and signaling (128bit AES)
- Joint feature between IPLA and DT7x0 (V2.2.1 firmware)
- Encryption to SV8100 or peer to peer between DT7x0's
- User can see if in secure speech mode: key present on DT7x0 display
- Not possible to listen to conversation by capturing packets on network
- Encryption license in SV8100

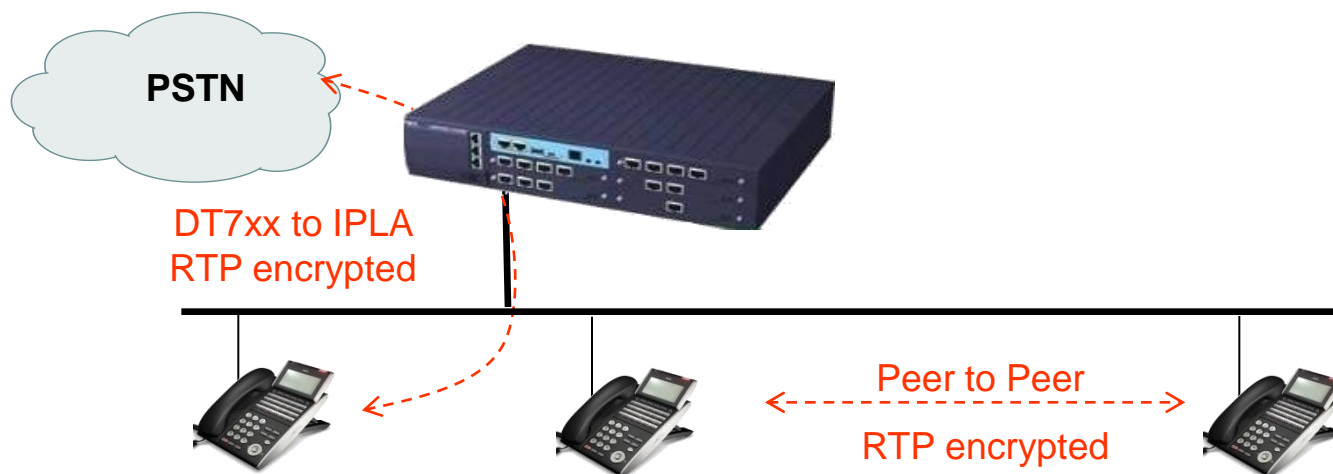

Encryption must be enabled at SV8100:

- PRG 10-46-07 *Enable SIP Encryption*
- PRG 10-46-09 *Enter password*
- PRG 84-27-03 *Enable RTP Encryption*

Encryption must be also be enabled at the DT7x0's requiring encryption:

- Menu followed by Password
- Option 2: SIP Settings
- Option 7: Encryption
- Option 1: Authentication Mode = enable
- Option 2: One Time Password = entry in PRG 10-46-09 Save

Encryption License in SV8100 required

NAPT

- VPN Tunnelling no longer required
- Supports NAT Routers
- IP Terminals must have a static IP address or use the MAC address function of a DHCP server
- “Dynamic NAT” used for example in a hotel room
 - Does not require NAT router to have port forwarding

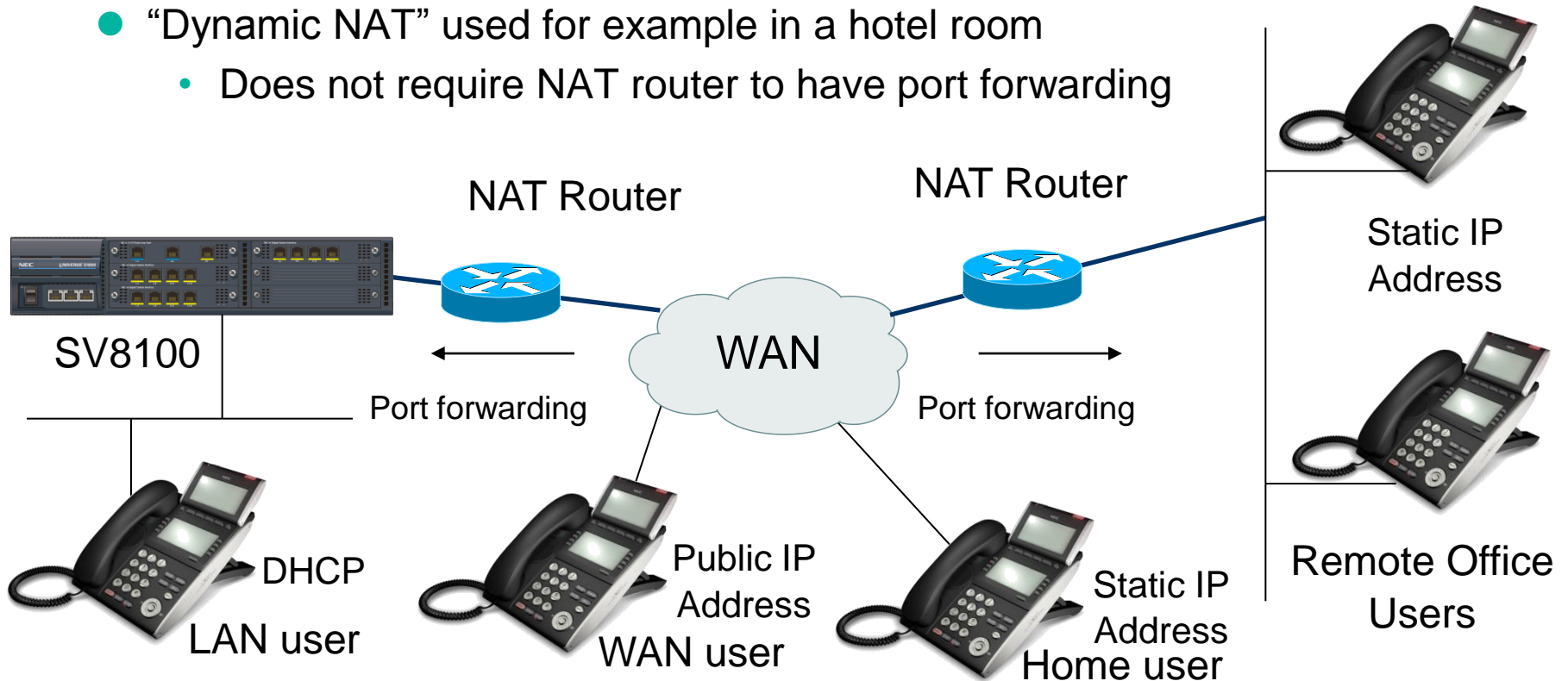

DT700 configuration settings, via:

- Phone menu
- Web browser^{new}
 - Access phone from your PC (password protected)
 - Admin and User mode
- (Automatic^{new}) configuration file load (FTP/TFTP)
 - E.g. to change your VLAN id
- DHCP
 - After initial startup, dhcp points to TFTP (to find config file)
- Download^{new} of
 - Music-on-Hold
 - Ringtone
-

Advantage: easier phone management

- Link Layer Discovery Protocol (LLDP standard) for VLAN conditioning
 - To enhance “plug and play” for the DT700
 - In a network that supports LLDP, the phone will automatically configure itself for the VoIP VLAN
 - then download the telephone configuration file from the TFTP server on that network.

Give phone a preconfigured IP address

- Phone becomes active with a preconfigured IP address if by chance the DHCP server is out of service or not found.
 - This allows the remote parties to continue normal activities

By default the following Ports are being used by ITL Terminals.

APPLICATION	TYPE	DEFAULT
SIP	TCP	5060
RTP (Send/Receive)	UDP	3482 - 3488
IPPhoneManager (Note1)	UDP	3530
TFTP Firmware Download (Sending)	UDP	69
TFTP Firmware Download (Receiving)	UDP	1024 - 5000
FTP Send (Defined by FTP Server)	TCP	20/21
FTP Receive (FTP Data)	TCP	1025
FTP Receive (FTP)	TCP	1024
DHCP (Send, Receive)	UDP	67, 68
DNS Send	UDP	53
DNS Receive	UDP	1024 - 5000
HTTP (Send/Receive) HTTP Server	TCP	80
HTTP (Send/Receive) XML Server	TCP	81
HTTP (Send/Receive) Push Server	TCP	82
HTTP (Send/Receive) HTTP Client	TCP	1024 - 5000

Note 1. The IPPhoneManager itself uses Port 20111.

XML

XML

- Wallpaper
- PBX Window Pop up

XML Applications

- BCT Client
- Tiger XML Guest Services
 - application specifically designed for the hospitality industry
See “SV8100 Sales Support Training – Hospitality”
- XML Software Development Kit (SDK) Partner Program
- Phone functions can be used in XML application



G.722 wide band codec

- Sampling rate 16 kHz (standard telephony: 8 kHz)
- 48 / 56 / 64 kbit/s bit rate (payload)
- Available for calls between DT730/750 phones



Superior audio quality and clarity

Agenda

- Overview

- DT3xx Digital phones

- DT7xx IP phones

Modularity \ Upgradeability

- Adapters

- Analogue phones

- SIP terminals

- Compatibility



Modularity \ Upgradeability

Over 8000 ways to personalize



Modularity \ Upgradeability

Desktop terminal

Bluetooth
Wireless
Handset

(only on
DT3xx)



DESI less

32 Button w/ LCD
24 Button w/ LCD
12 Button w/ LCD

DT730/DT330 #key upgrades

Modularity

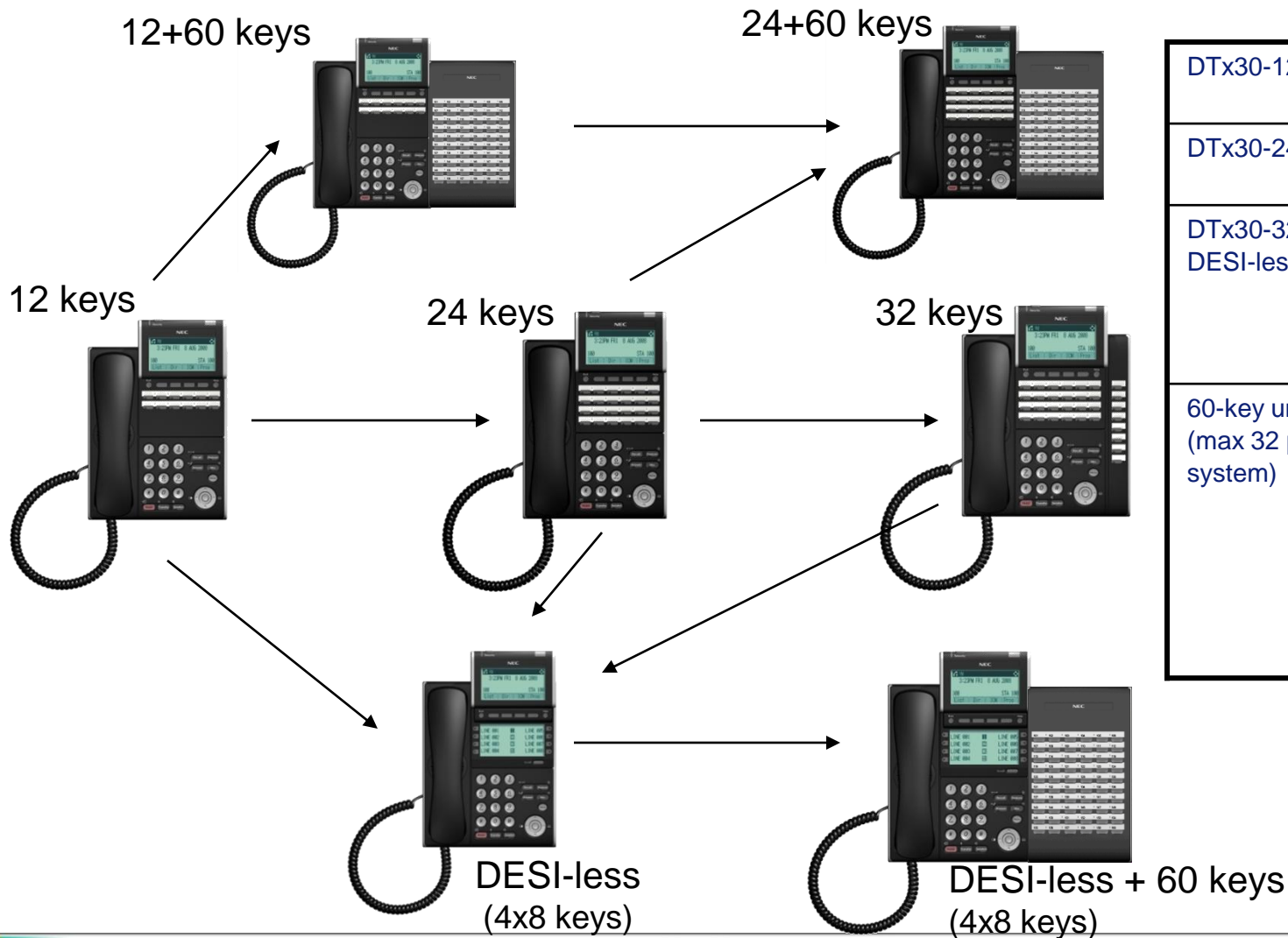

DTx30-12D	12x line/feature key
DTx30-24D	24x line/feature key
DTx30-32D, DESI-less	24x line/feature key + 8x speed dial + BLF
60-key unit (max 32 per system)	25x line key + 35x speed dial + BLF or 60x DSS + BLF/hotel room info

DSS console: (black or white)

- Direct Station Selection console
- 60 keys with red and green LEDs
- Gives user Busy Lamp Field (BLF)
- 1-button access to phones, trunks, SV8100 features
- Saves time for attendants, operators, dispatchers

AC adapter:

- For IP phone required
- Option for digital phone (depending on line length)

Installation:

- IP phone: Right of terminal – option slot connector on phone
1 IP DSS console per IP phone
- Digital: Direct connection DLCA port of SV8100



60 DSS Support on DT7xx

Modularity

Model	Type	Applicable	Voice Platforms
DT710	2/6 Button	No	SV8100, SV8300 from R1 and SV8500 for S3 Release
DT730	12/24 Button	Yes	
DT730	32 Button	No	
DT730	DESI Less	Yes	
DT730	Key set for ACD	No	
DT750	Business Mode Keyset	Yes	

NB:

DT750 can **not** be expanded with 8 line key unit AND DSS

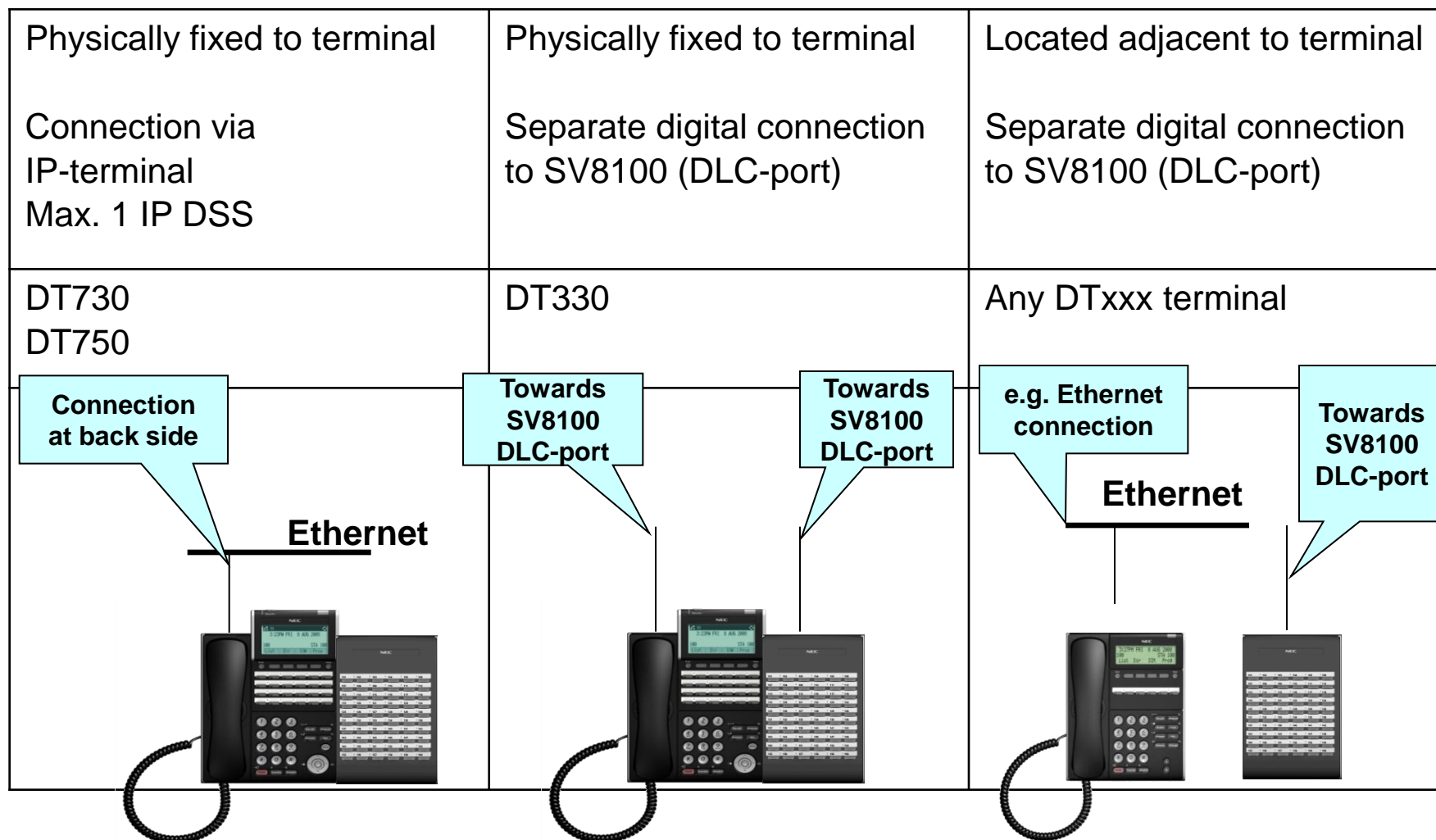

Business Layout (Standard)



Retro Keypad
(for DT330
compatibility
with 2000 IPS
or ASPIRE)
Not applicable for
DT310



Business Layout (French/Spanish)
Not applicable for DT310
and DT710 2E

8LK-L unit: →

- Provides 8 additional line keys to ITL or DTL terminals

12LK-L unit

- Provides 12 additional line keys to ITL or DTL terminals

8LKI-L unit

- Provides 8 additional line keys to DESI-less ITL terminals

8LKD-L unit

- Provides 8 additional line keys to DESI-less DTL terminals

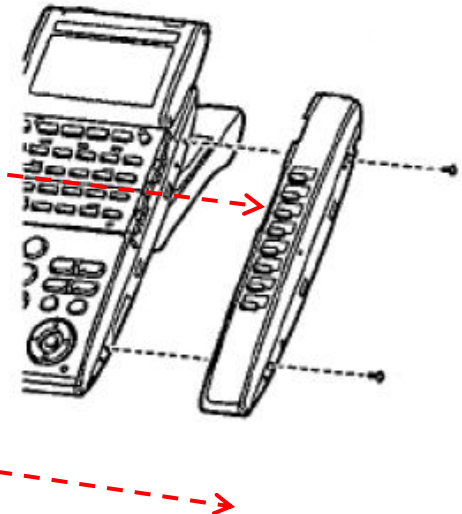

- DESI Less Pop Up
Indicates the events on the background
DESI less pages

- Manually
switch manually to the page
which has the activity

- Automatically
switches Automatically to the page
with which has the activity

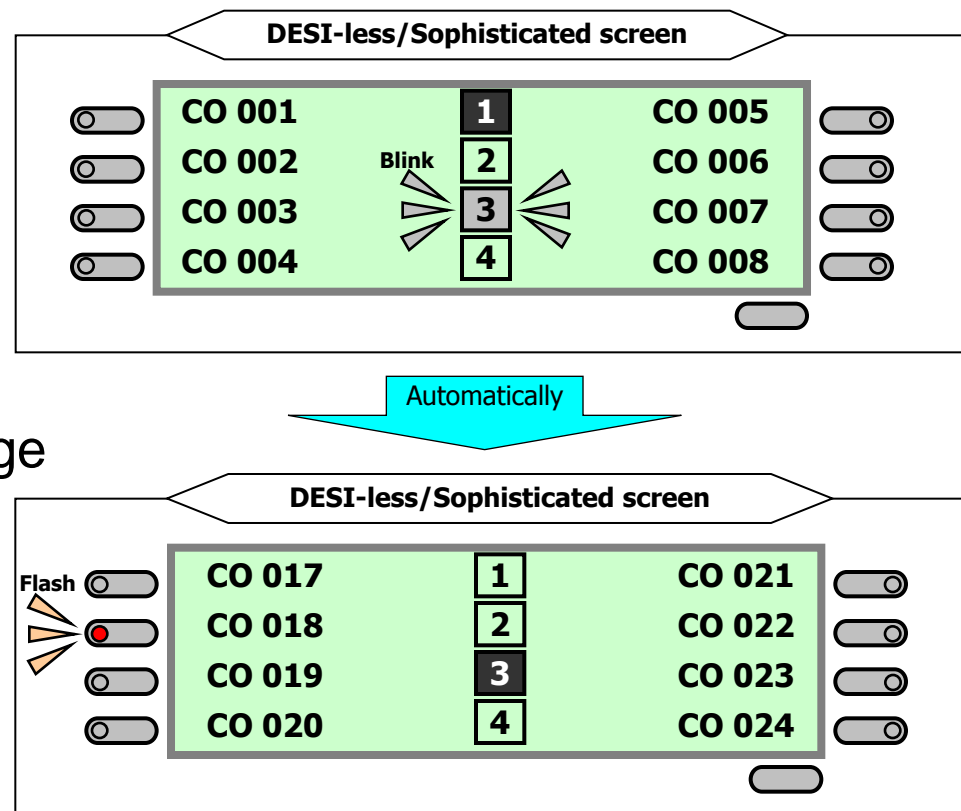



Interchangeable side and keypad panels



Note: actual colors may differ from the shown examples see [prophix](#)

Agenda

- Overview

- DT3xx Digital phones

- DT7xx IP phones

- Modularity \ Upgradeability

Adapters

- Analogue phones

- SIP terminals

- Compatibility



Adapters

■ AC/DC Adapter 24V/8W INT

- Power adaptor required for IP terminals

■ Wall mount unit, terminal (WM-L):

- Used to attach any Multiline Terminal to the wall
- Connects to the back side of the telephone and can be used in combination with the DTx30, DTx10 and DT750-series terminals

■ Wall mount unit, console:

- Used to attach the 60 button console to the wall
- This unit connects to the back side of the console

■ UTP Cat 5e cable:

- IP phones don't come equipped with line cords.
- 1 or 3 meter cord can be ordered to connect to the phones

Bluetooth is supported on the DT330 Only !

- Base side RF block: 50 meters, class 1
- Bluetooth distance: 50 meters
- Up to 16 handsets can be installed within 100m radius (open area) or 50m (confined/blocked area)



Bluetooth interfaces

- Bluetooth Cradle with integrated Bluetooth hub and Bluetooth handset (DT330-12Button/Bluetooth),
or
- Bluetooth Cradle with integrated Bluetooth hub and 3rd party Bluetooth earpiece/headset
or
- Bluetooth hub only (BHA-L) and 3rd party Bluetooth earpiece/headset



Bluetooth Hub Adapter (BHA)

- connects a Bluetooth device to a DT330.
- Up to eight Bluetooth devices can be located around the BHA-L UNIT,
 - Select which device can be paired with the BHA
 - Connecting the Paired Device

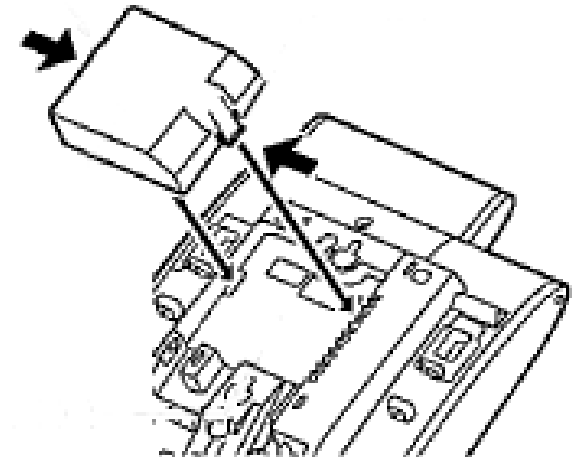

Supported Bluetooth headsets

- Plantronics headsets model numbers 360,
- Plantronics Voyager 520 & Discovery 665 and
- Motorola M500.



Supported functions

- Answer call or hang up by pressing button on headset
- Double click of the button on headset in idle state is seen as going off hook. (you will get dial tone)



Bluetooth handset

- LCD screen (with backlight)
- 8 line keys,
 - Access the functions preprogrammed on functionkeys 1 to 8 on the cradle.
 - display the status of the functions programmed on the buttons.
- 4 function keys, Cursor key
- Call history for 10 outgoing & 10 incoming calls
- Supported on DT330
- Cradle charges handset



Item	BTH (Bluetooth Handset)
LCD	120x82 dot matrix B&W LCD w/ Backlit 20x2 Alphanumeric characters (5x12 dot/font) 2 other lines are used for displaying icons.
Line key	8 (with Red & Green led)
Ten key	Ten-keys (0 - 9,*,#) with backlit
Cursor Keys	4 directions keys and 1 enter keys
Function keys	6 function keys (Talk, Disconnect, Hold, Recall, Transfer, F Key) - Controlled by SV8000
Headset jack	Yes
Message Waiting	Yes, Message Waiting Lamp
Soft keys	No
Distance	50m
Bluetooth	V2.0 class1 (Bluetooth restrictions apply to nr of paired handsets within a coverage area)
Other	S/W update can be supported. (BTH and PC are connected with NEC tool)

■ RJ11 analog port adapter, with ringer

- Only on DT330 (not IP phones)
- Connect to analog phone, fax, modem
- Provides ringing & voice which allows connected device to be used for incoming and outgoing calls
- Requires extra port to be configured in SV8100
- Provides a separate extension number for analog device, which allows both devices to be used at the same time (programming)
- 1 phone has 1 APR-L (mounted at bottom)
- Wall mount unit is required if the APR-L is installed on phone

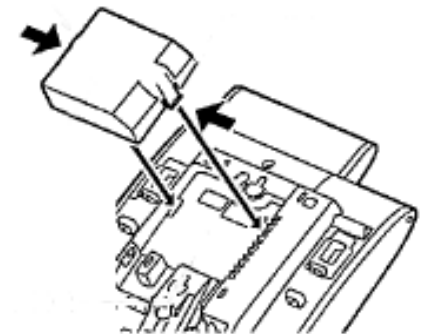

Ancillary Device Adapter

Analog recording adapter

- Supported on DT330, DT730, DT750
 - Record handset, headset or speakerphone speech
 - Voice send to recorder and receive from recorder
 - Hook switch info
 - Mini jack x 2
 - Install at bottom of phone
- Adapter output is 1/8" audio (mono) jack which you can connect directly to an AUX level input on a recorder or page amplifier
 - Wall mount unit is required if the ADA-L is installed on phone

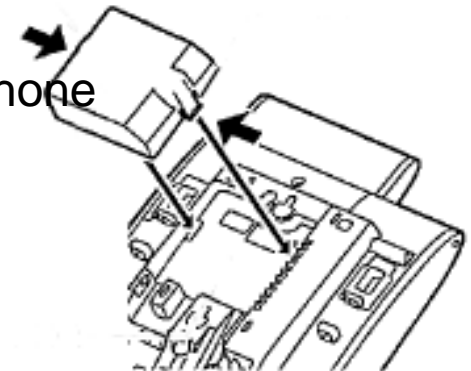

■ PSTN Fallback Adapter

■ Provides **Survivability** in case power failure or data network down

- Connects automatically to analogue port allowing calls to be made/received if e.g. VoIP link could not be used due to ADSL problems (where analogue line still functions)
- DT730, DT330
- No AC adapter
- Handset cradle needs to change
- Dedicated double-contact dial-button kit w/o backlit (replace standard dial-button kit on the telephone body)
- PSTN & PBX selection key and volume key on cradle surface
- MF / DP (10 pps) dial method



Install the new keypad panel supplied with the PSA-L UNIT.



Gigabit Adapter to desktop PC:

- Add-on for DT730 and DT750
- Connection to DT7x0 via one customer data socket
- Tilttable: 38°, 55°
- Powered via PoE (802.3af) or external power supply
- For external power an IP power adaptor should be purchased (27V)



Type-A Tilt 55°

Type-A Tilt 38°

Connection outline:

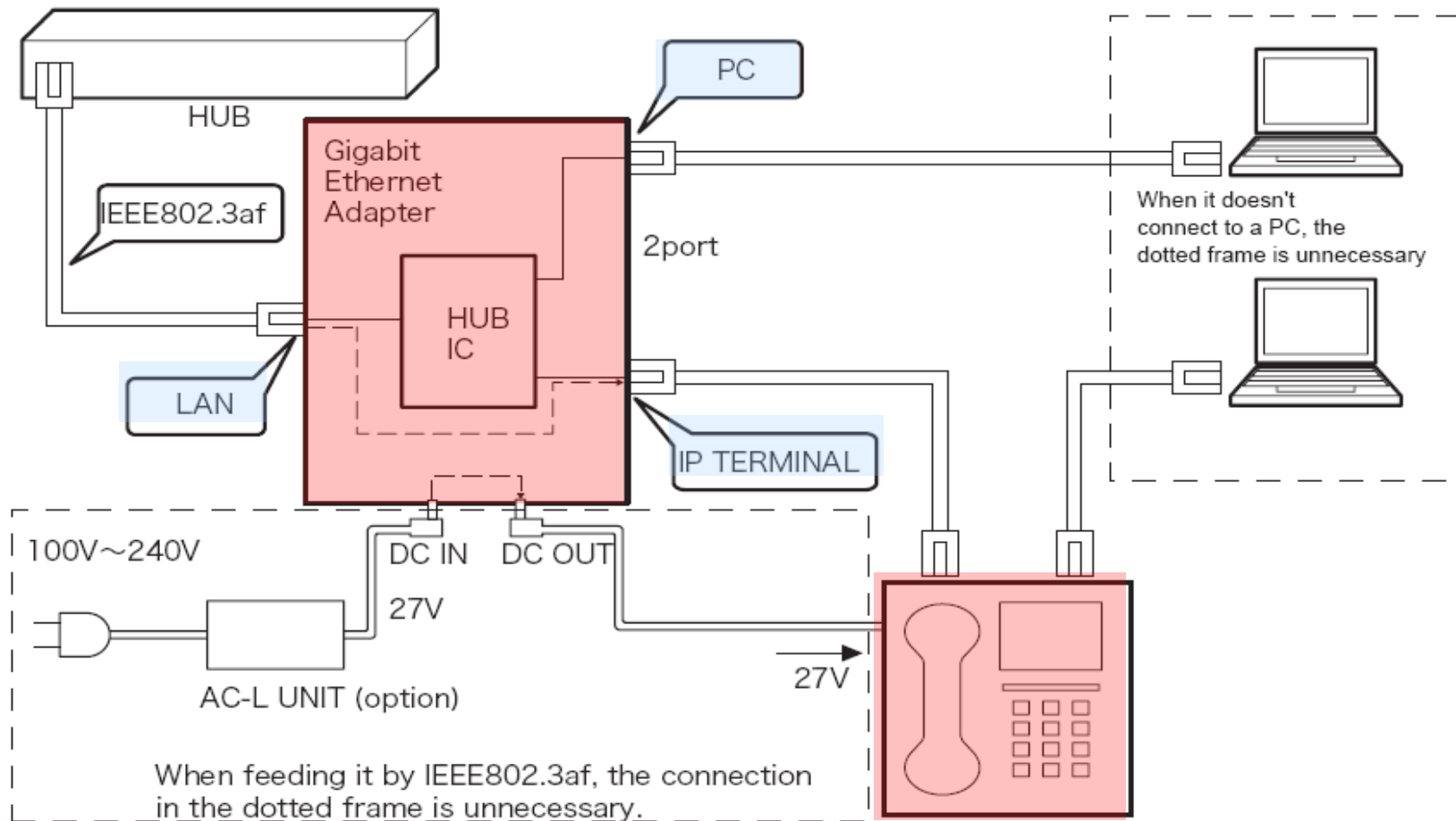

Gigabit adapter

Adapters

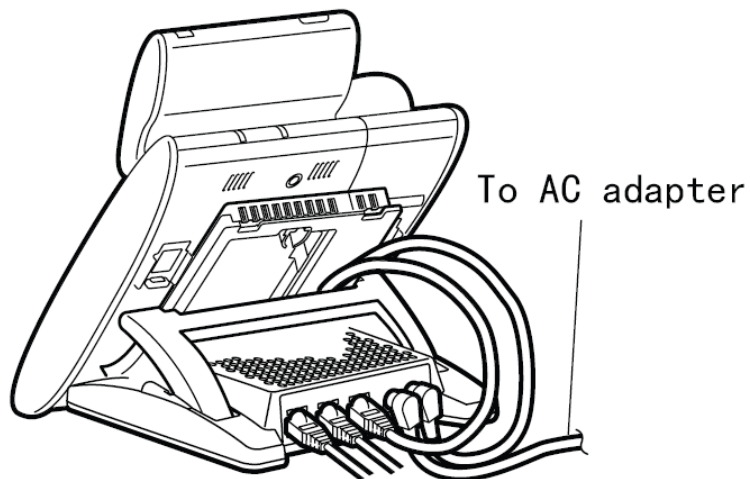

- | | |
|---|---|
| 1. Main Body | 1 |
| 2. Lan Cable for Terminal Connection (about 40cm) | 1 |
| 3. DC cable (about 30cm) | 1 |
| 4. Connection Manual (this sheet) | 1 |
| 5. Support Panel | 1 |
| 6. Leg Stand | 1 |

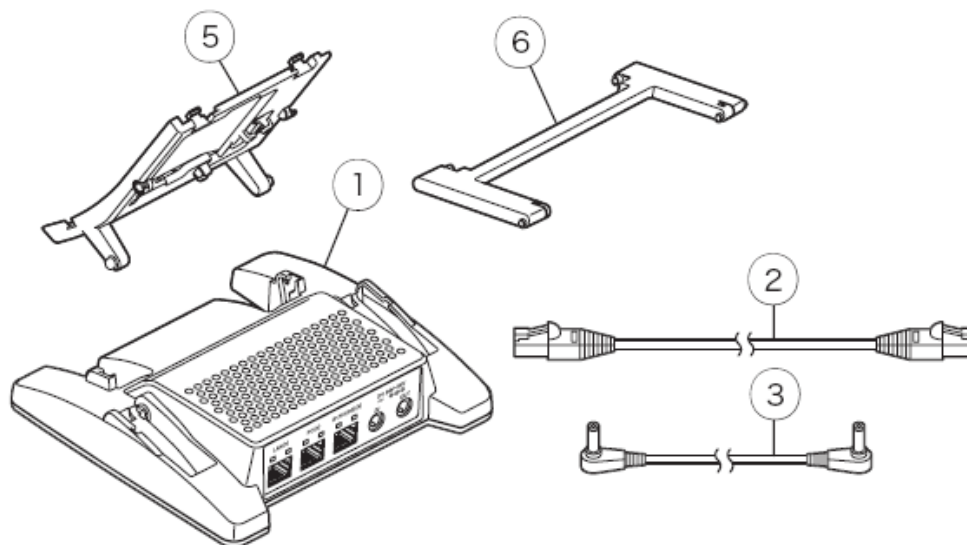

Connections:

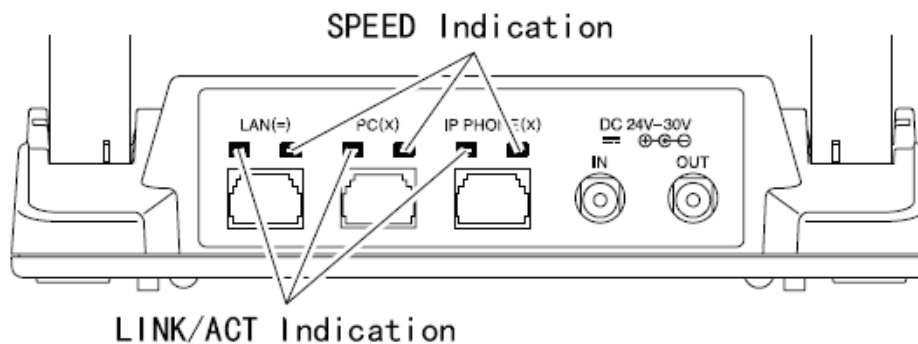

LINK/ACT Display

LED Name	LINK Time	ACT At time of communication
LINK/ACT Indication	Green Light	Blinking Green

Speed Display

LED Name	1000Mbps Connected	100Mbps Connect	10Mbps Connect
SPEED Indication	Green Light	Red Light	Off

Item		Contents
Interface	LAN	1000Base-T (IEEE802.3ab) / 100Base-TX (IEEE802.3u) / 10Base-T (IEEE802.3i) Auto Negotiation RJ45 connection
	PC	1000Base-T (IEEE802.3ab) / 100Base-TX (IEEE802.3u) / 10Base-T (IEEE802.3i) Auto Negotiation RJ45 connection
	IP Terminal	100Base-TX (IEEE802.3u) / 10Base-T (IEEE802.3i) Auto Negotiation RJ45 connection
Power Supply		PoE IEEE802.3af or DC 27V (AC-L UNIT)

Agenda

- Overview
- DT3xx Digital phones
- DT7xx IP phones
- Modularity \ Upgradeability
- Adapters
- Analogue phones**
- SIP terminals
- Compatibility



Analogue Phones

- Dial Pulse and DTMF analog single line telephones (SLTs)
- Message Waiting Indication (MW)
 - Technology: high voltage (Polarity Reversal is not supported)
 - Compatible with BaseLine Pro CLI
- Boards support Calling Line Identity Presentation (CLIP)
 - Technology: ETSI-FSK and DTMF (test reports available)
 - Compatible with BaseLine Pro CLI
- SLT users can dial codes to access subset of multiline features

Agenda

- Overview
- DT3xx Digital phones
- DT7xx IP phones
- Modularity \ Upgradeability
- Adapters
- Analogue phones
- SIP terminals**
- Compatibility



SIP Phones

Manufacturer:

SIP telephone:

■ ATL Telecom	IP300S
■ Counterpath	EyeBeam – softphone
■ Counterpath	X-lite – eyebeam
■ Grandstream	Budgetone 100
■ Grandstream	Budgetone 200
■ Grandstream	HandyTone 286 ATA
■ HP	iPAQ 514 Voice Messenger
■ Nokia	N80ie
■ Polycom	SoundStation IP4000
■ Snom	300
■ UTStarcom	F1000G
■ Thomson	ST2030
■ Interquartz	9339HS

*SIP extension compatibility
testing will be at
“payed for” basis*

Agenda

- Overview

- DT3xx Digital phones

- DT7xx IP phones

- Modularity \ Upgradeability

- Adapters

- Analogue phones

- SIP terminals

- Compatibility**



Standard phones

Compatibility

- DT300 series
- DT700 series
- Analogue SLT phones
- DesktopSuite SP310 softphone
- 3rd party SIP (soft) phones
 - SV8100 is RFC3261-compliant



IPC500\ASPIRE

- IP Phones (IP1WW-24TXIH \ 24BTIXH)
 - Require License LK-SYS-IP-Terminal-1-LIC (BE107585)
 - Only basic telephone functions
- Digital phones
 - programming of keys may not be OK
 - Dterm DTR (Model B)
 - ASPIRE Digital phone (Model C)

Dterm IP phones

- (IP Protims support; backward compatibility)

Dterm Digital phones

- (Digital interface the same as DT300), IPK Digital



SV8100 ↔ ASPIRE

Compatibility

Aspire



SV8100



+



Retro Keypad

DT300 + Retro Keypad acts as a
MODEL-B telephone.
System software >7.63

Licenses

DT7xx terminal	BE 107585	LK-sys-ip-terminal-1-lic
VWLAN terminal	BE 107585	LK-sys-ip-terminal-1-lic
DECT handset	EU909033	NEC-SIP-License
BCT HMP Port	EU909033	NEC-SIP-License
3 rd party SIP terminal	BE107586	lk-sys-ip-terminal-sip1-lic

Empowered by Innovation

NEC